



## Info-Point No. 34

July 2010

### Content

<b>1</b>	<b>Catalogue corrections.....</b>	<b>2</b>
1.1	Replacement glue for Z 908909 .....	2
1.2	Invalid installation drawing Lambda Window .....	2
1.3	Updated list for round glazing beads for Lambda .....	2
<b>2</b>	<b>HueckTec .....</b>	<b>3</b>
2.1	New functions in HueckTec .....	3
<b>3</b>	<b>Catalogue updates .....</b>	<b>6</b>
3.1	New catalogue updates .....	6

### Annex



## 1 Catalogue corrections

### 1.1 Replacement glue for Z 908909

On the fitting installation drawing 8205-01, contained in the catalogue „Volato S 04/2009“ the glue Z 908909 is shown. This article is not available. As a replacement, the glue **Z 903941** is usable.

*The updated installation drawing (Volato S 04/2009 – fitting installation, 8205-02) can be found in the annex.*

### 1.2 Invalid installation drawing Lambda Window

The installation drawings **3001-01** and **3003-01** are contained in the catalogue „Lambda Window 12/2009“. These drawings are not valid and may not be used.

The valid drawings **3001-02** and **3003-02** are on the back sides.

### 1.3 Updated list for round glazing beads for Lambda

The topic „round glazing beads from series 1.0 can be used for Lambda“ from the last Info-Point No. 33 has been updated. The glazing tables for the sash frames were **not correct**.

*The updated pages III and V from the Info-Point No. 33 can be found in the annex.*



## 2 HueckTec

### 2.1 New functions in HueckTec

#### Direct printing of drawings:

Direct printing is a new function offered by HueckTec. This function enables a direct output of drawings from the element construction at a single click. Including detail points if sections have been positioned through the element, or else only the projection is shown. If a position info text has been entered for the element, it is output as a cover sheet together with the description of the position and the number of items. The description fields are automatically populated with the corresponding information on the element and/or object. In this way, drawings are automatically created by HueckTec.

Samples:

Front page

<b>Position: Meixnr</b>		Zeich. Nr.:	
Stückzahl: 1		1	
Ansicht von außen			
Haustürelement Aluminium			
Serie Hueck 1.0 Tür			
Bautiefe 72mm, Rahmen 68mm			
einflügelig mit Seitenteil, schlosseiteig			
DIN rechts nach innen öffnend			
Rahmen und Flügel weiß			
innen RAL 9016, außen RAL 9016			
3 Stück 2-teilige Bänder weiß			
ohne Drücker innen			
Griffstange außen + innen, gerade, türhoch, Edelstahl			
1 Stück Profilzylinder Not- und Gefahrenfunktion			
3 Stück Schlüssel			
1 Stück Obentürschließer, weiß mit Feststeller			
Glas Iso-Float 2x VSG 6mm sandgestrahlt Ug 1.1			
mit 5 quadratischen klaren Feldern, 100x100 mm,			
übereinander, Abstand je 100 mm; seitlich Richtung			
Schloss versetzt			
Fußbodeneinstand 0 mm, Standardschwelle			
BV / Beschreibung / Inhalt: Kunde, Objektbezeichnung Position, Deckblatt		Ident-Nr.: Identnummer	
gez. Schippmann	30.06.2010	Apr.	Ident-Nr.:
gepr.		Mei/16	Identnummer

View

BV / Beschreibung / Inhalt: Kunde, Objektbezeichnung Position, Ansicht		Zeich. Nr.: 2	
gez. Schippmann	30.06.2010	Apr.	Ident-Nr.:
gepr.		Mei/16	Identnummer



Samples:

**Vertical sections**

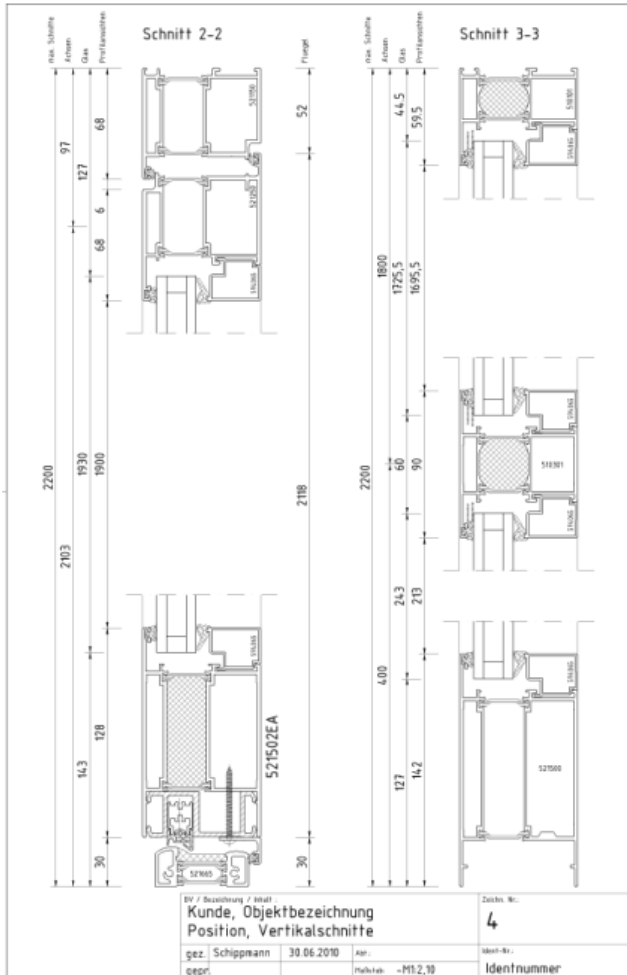

**Horizontal sections**

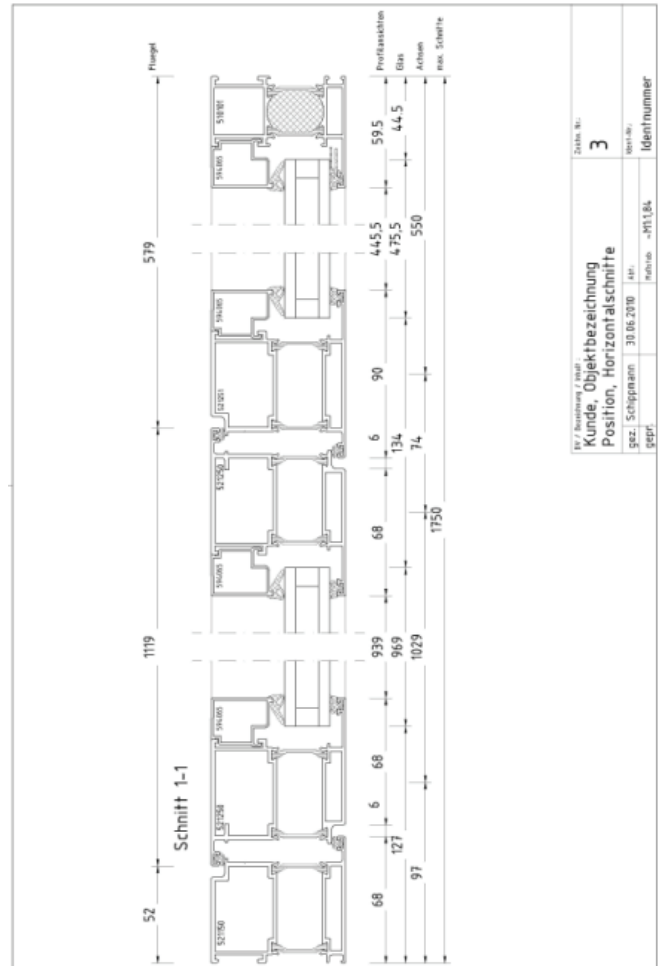

Creation of layouts:

The settings for the drawing generation also enable the selection of creating section layouts. In this case, areas which correspond to these exact drawings are created upon transfer to the CAD. This function is similar to direct printing.

Projection in clipboard:

If you wish to use the projection as shown in the element construction in another application, e.g. Word, you can transfer it to the Windows clipboard. The projection can then be inserted at the current position in another application by means of CTRL-V.



New minimization

schnell	
Lagerlänge	<input type="text" value="0"/> mm
gesamte Endabzüge	<input type="text" value="18"/> mm
<b>Optimierung</b>	
optimal	
<input checked="" type="checkbox"/> Fixlängenermittlung	
min. Fixlänge	<input type="text" value="6450"/> mm
Schrittweite	<input type="text" value="53"/> mm
max. Fixlänge	<input type="text" value="6450"/> mm

Minimization has been renewed so that better results for the material required, the section sequence and the optimization of fixed lengths are achieved.

Minimization has been extended by optimum administration of remaining lengths.

<input checked="" type="checkbox"/> Restlängenverwaltung	
Bitte die Länge (in mm) angeben, ab der ein Stab in die Restlängenverwaltung übernommen werden soll:	
<input type="text" value="1000"/> mm	
<input type="button" value="Restlängen manuell verwalten/ anzeigen"/>	
Bevorzugung Restlängen	
<input checked="" type="radio"/> überhaupt nicht	
<input type="radio"/> ....	
<input type="radio"/> ....	
<input type="radio"/> möglichst	



## 3 Catalogue updates

### 3.1 New catalogue updates

Updated catalogue pages are available as PDF files to download from our homepage from now on. From time to time corrected pages or series extensions can be downloaded and printed. A regular list contains all changes for all profile series.

*The linked list of the updated catalogue pages can be found in*

[http://www.eduard-hueck.com/metalwork-shops/info-point/catalogue updates](http://www.eduard-hueck.com/metalwork-shops/info-point/catalogue%20updates)

[\(<http://www.eduard-hueck.de/hueck-de-de/1806.html>\)](http://www.eduard-hueck.de/hueck-de-de/1806.html)