

Stanzmesser und Stanzwerkzeuge: siehe Register **Werkzeuge**
Punch knives and punching tools: refer to register **Tools**

M 1:1
Scale 1:1

	Außenkammer External profile chamber					Innenkammer Internal profile chamber					
	I					II					
verpressbar crimpable verstiftbar nailable nachträglich verklebbar retro gluing after assembly											
B 809000	Z 914369	-	-	-	-	-	Z 911486	Z 911488	2 x Z 900023	Z 911187	Z 914452
B 809010	Z 914369	-	-	-	-	-	Z 911956	Z 912316	2 x Z 900023	Z 911187	Z 914452
B 809030	Z 914369	-	-	-	-	-	Z 911120	Z 911121	2 x Z 900023	Z 911187	Z 914452
B 809050	Z 914369	-	-	-	-	-	Z 914425	Z 914424	2 x Z 900023	Z 911187	Z 914452
B 809000	-	Z 914368/370	-	-	Z 914487	-	Z 914382	-	2 x Z 914351	Z 911187	Z 914452
B 809010	-	Z 914368/370	-	-	Z 914487	-	Z 914383	-	2 x Z 914351	Z 911187	Z 914452
B 809030	-	Z 914368/370	-	-	Z 914487	-	Z 914385	-	2 x Z 914351	Z 911187	Z 914452
B 809050	-	Z 914368/370	-	-	Z 914487	-	Z 914387	-	2 x Z 914351	Z 911187	Z 914452

007000300





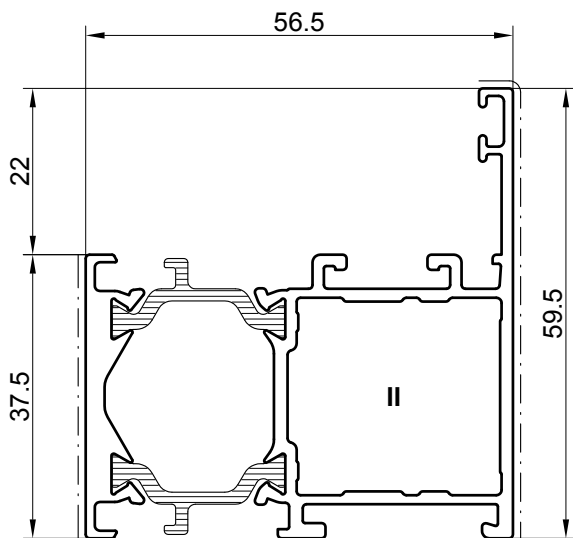



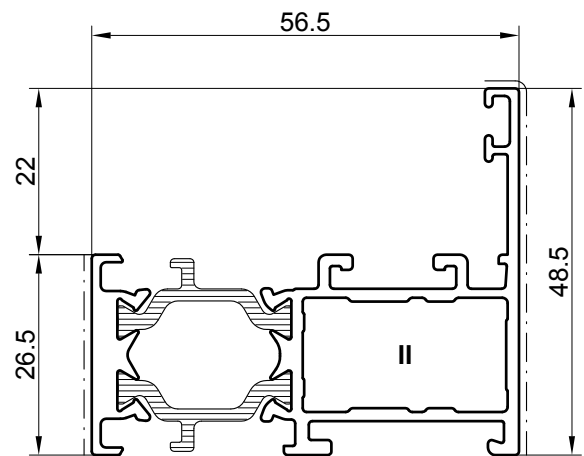





B 809140

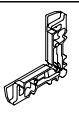

B 809150

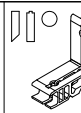
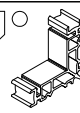

M 1:1
Scale 1:1

<ul style="list-style-type: none">  verpressbar crimpable  verstiftbar nailable  nachträglich verklebbar retro gluing after assembly 	Außenkammer External profile chamber					Innenkammer Internal profile chamber					
											
B 809140	-	-	-	-	-	-	Z 911027	Z 911030	2 x Z 900023	Z 911187	Z 914770
B 809150	-	-	-	-	-	-	Z 911486	Z 911488	2 x Z 900023	Z 911187	Z 914770

008001500

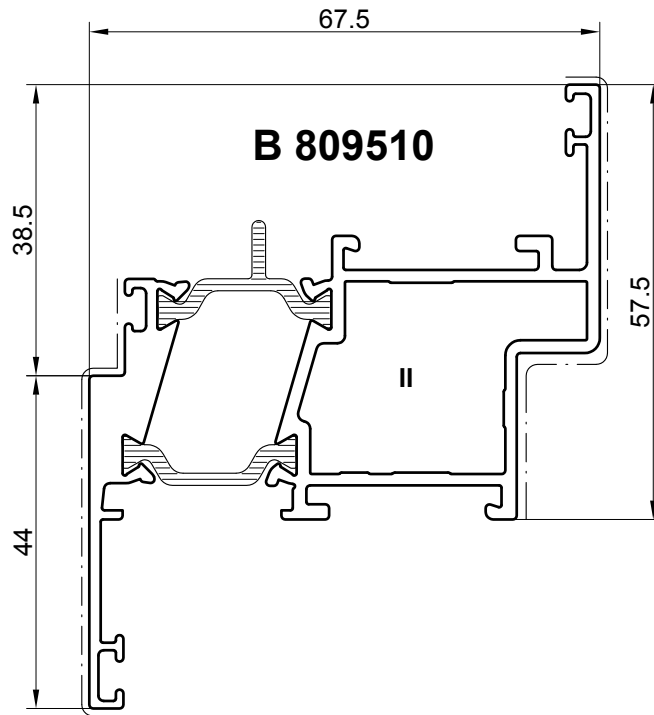
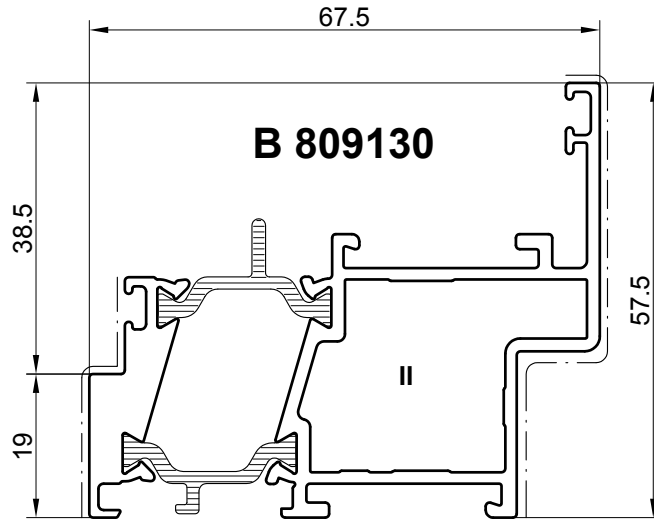

* Bei Einsatz eines Senk-Klapp Beschlages für obere Ecken erforderlich. Bitte Verarbeitungshinweise beachten!

* If using a top-hung projecting out window stay-arm, for upper edges required. Please refer to Processing!

Stanzmesser und Stanzwerkzeuge: siehe Register **Werkzeuge**
Punch knives and punching tools: refer to register **Tools**

M 1:1
Scale 1:1

009001201

	Außenkammer External profile chamber					Innenkammer Internal profile chamber						
	I	II				I	II					
verpressbar crimpable verstiftbar nailable nachträglich verklebbar retro gluing after assembly												
B 809130	-	-	-	-	-	-	Z 914569	Z 914713 Z 914570 *	2 x Z 900023	Z 911187	Z 914574	
B 809510	-	-	-	-	-	-	Z 914569	Z 914713 Z 914570 *	2 x Z 900023	Z 911187	Z 914574	

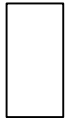

B 809900

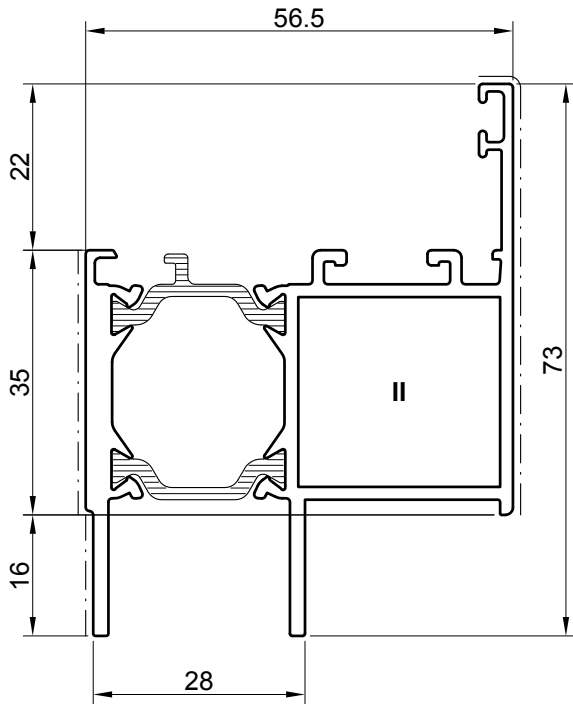

B 809930

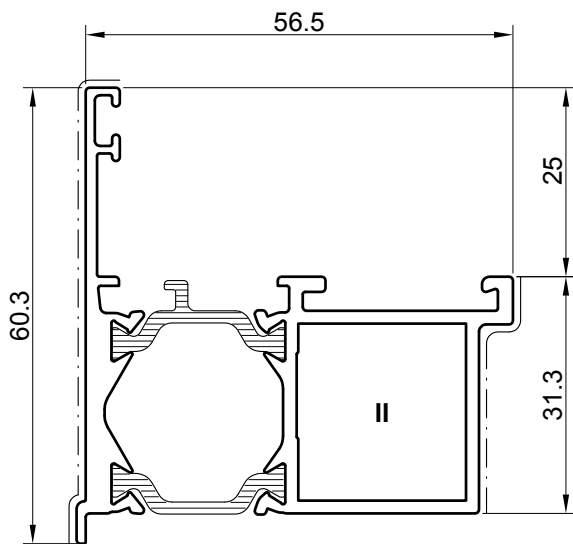

B 809940

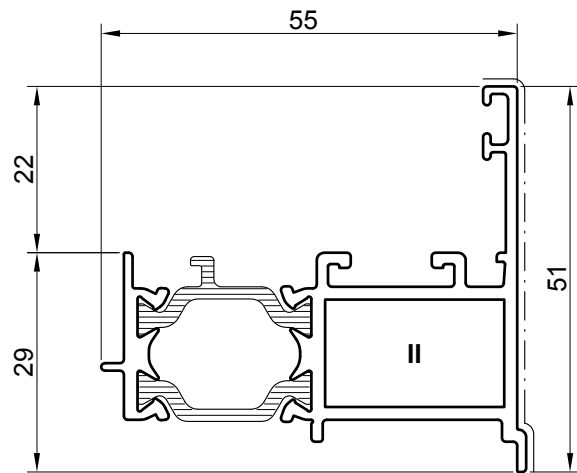

M 1:1
Scale 1:1

	Außenkammer External profile chamber					Innenkammer Internal profile chamber					
	I	II				I	II				
<ul style="list-style-type: none"> verpressbar crimpable verstiftbar nailable nachträglich verklebbar retro gluing after assembly 											
B 809900	-	-	-	-	-	-	Z 911027	Z 911030	2 x Z 900023	Z 911187	Z 914770
B 809930	-	-	-	-	-	-	Z 914992	Z 914991	2 x Z 900023	Z 911187	Z 914452
B 809940	-	-	-	-	-	-	Z 914994	Z 914993	2 x Z 900023	Z 911187	Z 914770

010001801

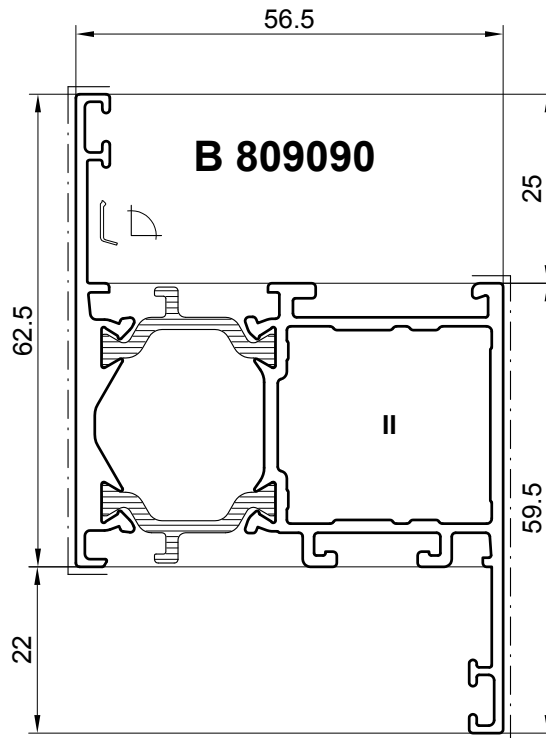
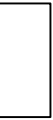

Einsatz als Rahmen für Verglasung von außen: Bohrschablone Z 914770 verwenden
In case of glazing from the outside: please use drill jig Z 914770

Stanzmesser und Stanzwerkzeuge: siehe Register **Werkzeuge**
Punch knives and punching tools: refer to register **Tools**

M 1:1
Scale 1:1

01.10.00600

	Außenkammer External profile chamber					Innenkammer Internal profile chamber					
		I					II				
<ul style="list-style-type: none"> verpressbar crimpable verstitfbar nailable nachträglich verklebbar retro gluing after assembly 											
B 809090	Z 914369	-	-	-	-	-	Z 911027	Z 911030	2 x Z 900023	Z 911187	Z 914770
B 809090	-	Z 914368/370	-	-	Z 914487	-	Z 914384	-	2 x Z 914351	Z 911187	Z 914452