

Door-Series

Door-Series

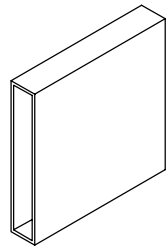

P 599 001
Push bar,
aluminium square tube,
100 x 18 mm
Stock length = 5 m

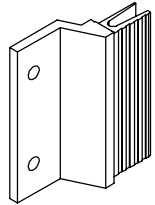

Z 902 134 00
Support for push bar,
height = 30 mm,
suitable for P 599 001

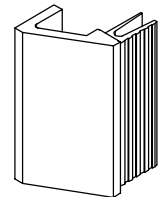
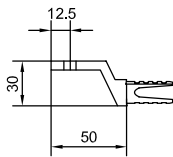

Z 902 126 00
Support for push bar,
height = 50 mm,
suitable for P 599 001

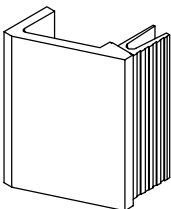
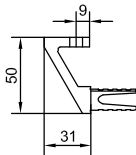

Z 902 130 00
Support for push bar,
height = 65 mm,
suitable for P 599 001

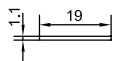
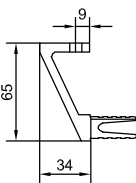

Z 908 355
Adhesive tape,
adhesive on both sides,
19 x 1.1 mm (3M Type 4939F)
required for gluing push bar
P 599 001



Z 908 394
Threaded rod made of V 2A
M8 / M6 x 28 mm
for fixing push bar P 599 001



Z 900 943 02
Z 900 943 64
Aluminium capnut M8,
for fixing push bar with
Z 908 394

2.1 EU

•

•

•

•

•

•

•

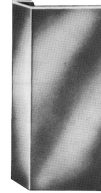

Z 900 939 02
Aluminium door handle
110 x 220 mm

Z 911 165
Fixing plate for push
grips with 190 mm
hole pitch as well as for
150 X 150 mm
with 70 mm hole pitch

Z 911 163
Threaded rod
made of V2A, M8 x 100,
for fixing the supports
with door handles or
push bars

Z 906 359
Threaded rod
made of V2A, M8 x 20,
for fixing with fixing plate
Z 911 165

2.1 EU

•

•

•

•