

## Sash arrangement for HUECK 1.0 parallel sliding and tilting elements (internal view)

**Scheme A**

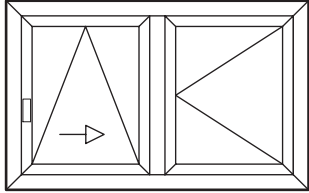

**Left side**  
Sliding sash / side-hung  
sash with centre  
mullion

**Scheme A**

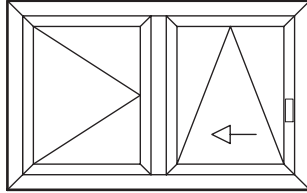

**Right side**  
Sliding sash / side-hung  
sash with centre  
mullion

**Scheme D**

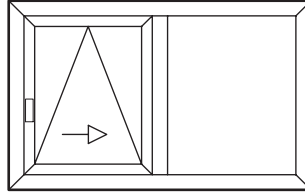

**Left side**  
Sliding sash / fixed glazing  
with centre  
mullion

**Scheme D**

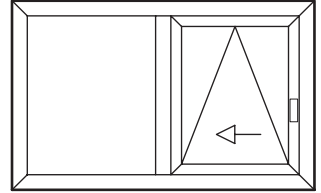

**Right side**  
Sliding sash / fixed glazing  
with centre  
mullion

**Scheme G**

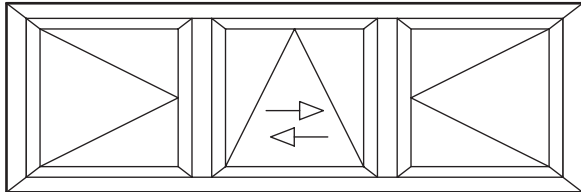

**Left or right side**  
Sliding sash / 2 side-hung  
sashes with centre  
mullion

**Scheme H**

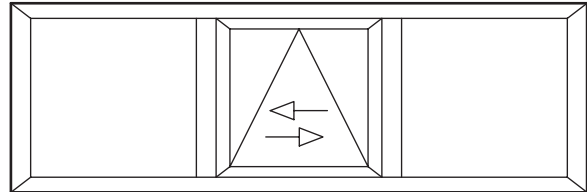

**Left or right side**  
Sliding sash / 2 fixed glazing with centre  
mullion

**Scheme K**

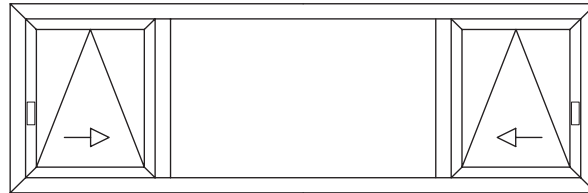

**Left and right side**  
2 sliding sashes / fixed glazing

**Scheme C**

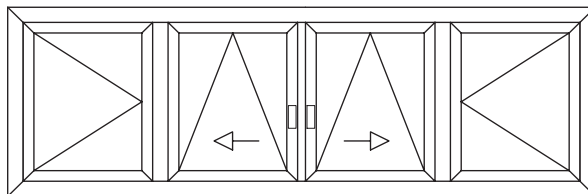

**Left and right side**  
2 sliding sashes / 2 side-hung  
sashes  
(secondary sashes)

**Scheme F**

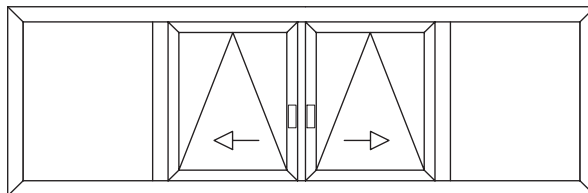

**Left and right side**  
2 sliding sashes / 2 fixed glazing  
(secondary sashes)

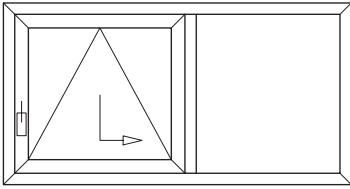

Internal view,  
left of figure

### Application and sash size diagram for parallel sliding and tilting fittings

Valid for a sash weight of 100 kg

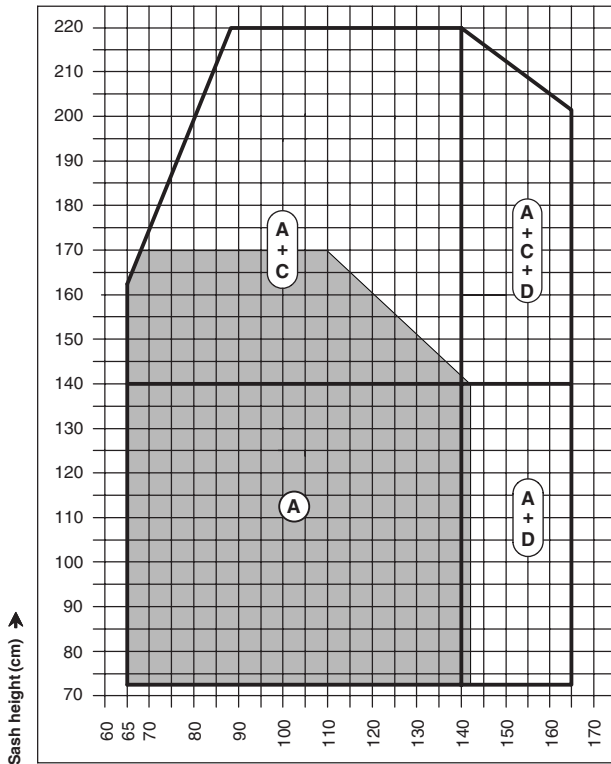

Sash width (cm) →

■ B 510 200

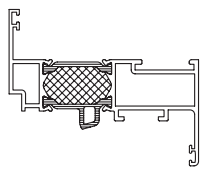

□ B 510 201

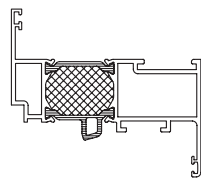

Ⓐ Basic fitting

Ⓒ  
or  
Ⓓ Additional lock

Max. sash size 3.2 m<sup>2</sup>  
Max. sash width 1650 mm  
The ratio of sash width and  
sash height should not exceed 1:2.5

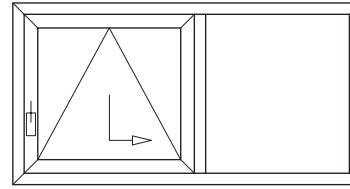

Internal view,  
left of figure

### Application diagram for parallel sliding and tilting fittings

Valid for a sash weight of 150 kg

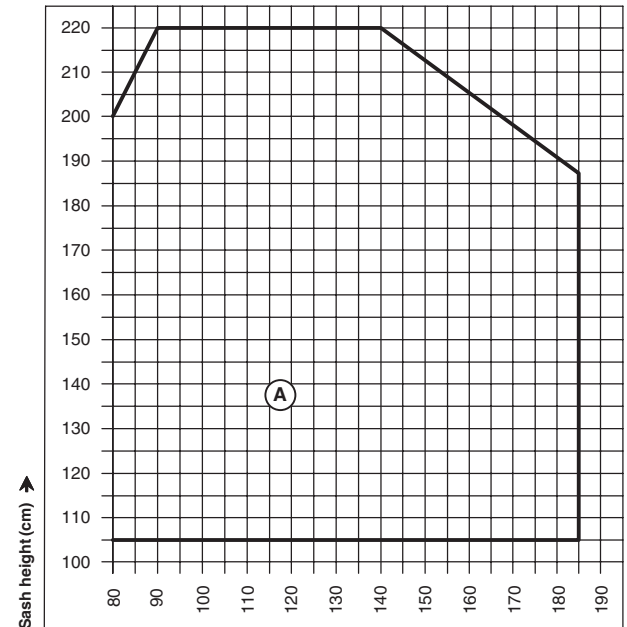

Sash width (cm) →

□ B 510 201

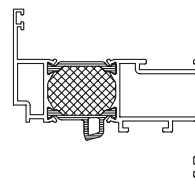

□ B 510 202

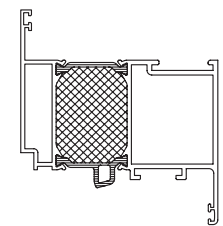

Ⓐ = Basic fitting

Max. sash size 3.4 m<sup>2</sup>  
Max. sash width 1850 mm  
The ratio of sash width and  
sash height should not exceed 1:2.5

Attention:  
In case of secondary sash design, a maximum  
sash width of 2 x 1650 mm is possible.

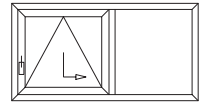

Parallel sliding and tilting fitting, for parallel sliding and tilting element in case of Scheme A to F,  
max. sash weight = 100 kg  
Processing and assembling drawing: Register 800

## Series

1.0

- (A) **Basic fitting, excluding handle, for one sliding sash**  
**Z 994 374 DIN L**  
**Z 994 375 DIN R**  
 Central lock, complete, including tandem roller and fixing material, excluding operating rods **P 496 099**



**Sliding stay-arm, depending on the sash width, required in addition to the basic fitting**

- Z 909 233**  
**Size 1**  
 for sash width between 650 and 930 mm
- Z 909 234**  
**Size 2**  
 for sash width between 931 and 1280 mm
- Z 909 235**  
**Size 3**  
 for sash width between 1281 and 1650 mm

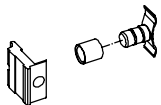

**Z 993 437**  
 Additional locking, required from:

- (C) **Sash width** = 1401 mm  
 (D) **Sash height** = 1401 mm

For the basic fittings  
**Z 994 374 / 375 handles**  
**Z 911 590 02/64** and  
**Z 911 592 02/64** can be used.

## Series

1.0

**Required accessories for secondary sash design Scheme C + F**

**Z 907 687**  
 Set of operating rods, punched, for secondary sash length = 2000 mm

**Z 905 376 and Z 905 574**

Coupling piece, required for set of operating rods, in case of unfavourable heights

**Z 994 087**

**1 Set**  
 End pieces for secondary sash profile, complete with shaped gasket pieces, **white**

**Z 994 088**

**1 Set**  
 End pieces for secondary sash profile, complete with shaped gasket pieces, **black**

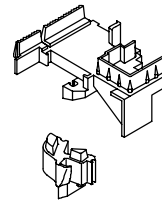

Please observe the application diagrams!

Parallel sliding and tilting fitting with assisted opening function,  
for parallel sliding and tilting element in case of Scheme A to F; max. sash weight = 150 kg  
Processing and assembling drawing: Register 800

## Series

1.0

Basic fitting,  
excluding handle,  
for one sliding sash

**Z 994 242 DIN L**  
**Z 994 243 DIN R**

Central lock, complete,  
with handle gear, without turn handle,  
including tandem rollers and stay-arms,  
catching plates and fixing material,  
excluding operating rods **P 496 099**

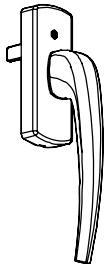

Turn handles,  
suitable for basic fittings

**Z 993 433 02 DIN L**  
**Z 993 433 64 DIN L**  
**Z 993 434 02 DIN R**  
**Z 993 434 64 DIN R**

Turn handle,  
including fixing plate

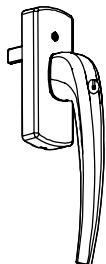

**Z 993 452 02 DIN L**  
**Z 993 452 64 DIN L**  
**Z 993 453 02 DIN R**  
**Z 993 453 64 DIN R**

Turn handle, lockable,  
including fixing plate

Please observe the application diagrams!

## Series

1.0

As an alternative, the basic fittings  
can be fitted with a rebate gear if  
profile **B 510 202** is used.

**Z 994 248**

Rebate gear,  
suitable for basic fittings,  
designed for profile cylinder,  
backset = 27.5 mm,  
only possible in combination  
with profile **B 510 202**

Turn handles,  
suitable for rebate gears

**Z 993 441 02**  
**Z 993 441 64**

Turn handle, suitable for  
use on left and right side,  
designed for profile cylinder,  
on one side - for inside operation

**Z 994 326 02**  
**Z 994 326 64**

Turn handle, suitable for  
use on left and right side,  
designed for profile cylinder,  
on both sides - for inside and  
outside operation

**Z 906 308**

Profile semi-cylinder,  
extended by 10 mm,  
with 3 keys,  
for inside operation

**Z 911 376**

Profile cylinder,  
extended by 10/35 mm,  
with 3 keys, for inside  
and outside operation

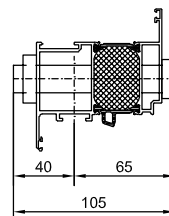
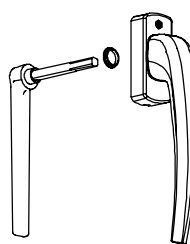
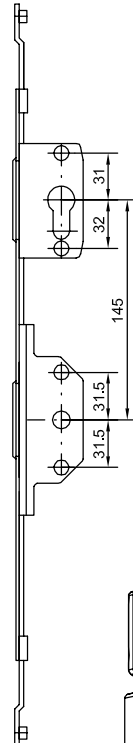

**Attention:** In case of roller shutter guides and outside operation, only supplementary profiles **P 496 038**, **P 496 044**, **P 496 095**, **P 596 077** may be used! (cf. Register ZP)

Parallel sliding and tilting fitting, for parallel sliding and tilting element in case of Scheme A to F  
 max. sash weight = 150 kg  
 Processing and assembling drawing: Register 800

Series

1.0

Max. sash weight = 150 kg

Basic fitting with assisted opening function for secondary sash Scheme C + F

**Z 994 244 DIN L**  
**Z 994 245 DIN R**

Central lock, complete, with handle gear, without turn handle, including secondary sash locking, tandem rollers and stay-arms, catching plates and fixing material, excluding operating rods **P 496 099**

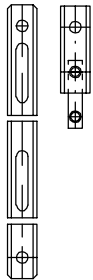

In case of secondary sash design, the following additional fitting pieces are required Scheme C + F

**Z 993 471**

Additional parts for secondary sash, punched operating rods, length = 2000 mm, and coupling parts

**Z 994 087**

**1 Set**  
 End pieces for secondary sash profile, complete with shaped gasket pieces, **white**

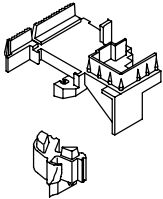

**Z 994 088**

**1 Set**  
 End pieces for secondary sash profile, complete with shaped gasket pieces, **black**

**Attention!**

In case of secondary sash design, a maximum sash width of 2 x 1650 mm is possible.

Series

1.0

Locking and hinge sets for side-hung sashes, suitable for parallel sliding and tilting fittings in case of Scheme A, C and G  
 max. sash weight for side-hung sash = 80 kg

**Attention!**

Cutting for sash width  $\leq 700$  mm:  
**FB = LRB + 8 mm**

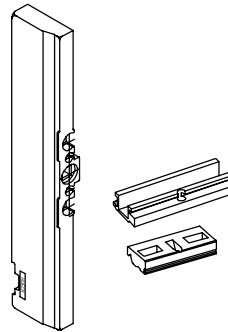

**Z 994 084**

Locking set, including rebate gear and ramp set, excluding window handle

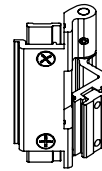

**Z 993 419 02**  
**Z 993 419 64**

Side-hung sash hinge, clamp-on design, three-part, suitable for DIN L and DIN R, can be used as a centre hinge

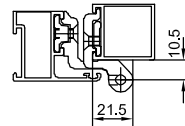

Minimum space required at the frame = 22 mm

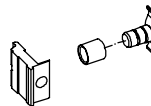

**Z 994 162**

Additional vertical lock on lock side

The hinge may also be used as a centre hinge on hinge side

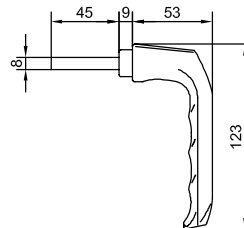



**Z 911 758 64**

Square socket key, suitable for locking set **Z 994 084**

**Z 906 478 02**  
**Z 906 478 64**

Rosette, suitable for locking set **Z 994 084**

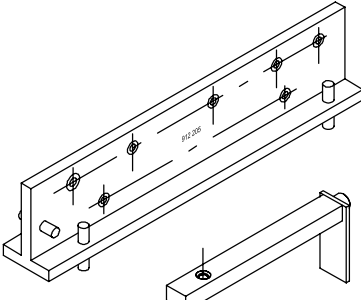
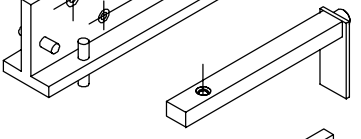
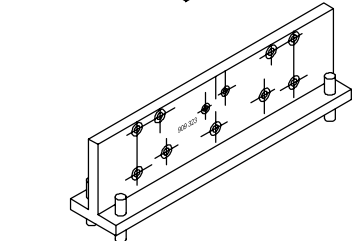
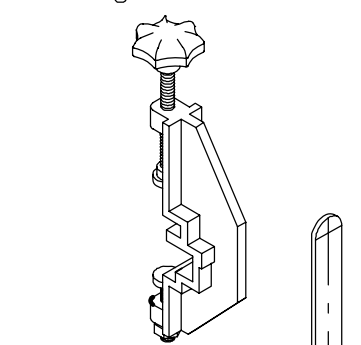
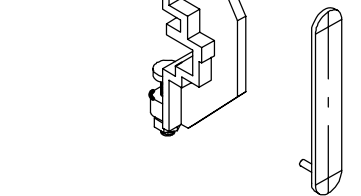
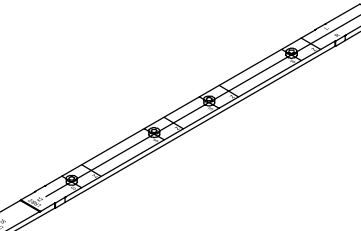
Parallel sliding and tilting fitting, for parallel sliding and tilting element in case of Scheme A to F  
 max. sash weight = 100 kg / 150 kg  
 Processing and assembling drawing: Register 800

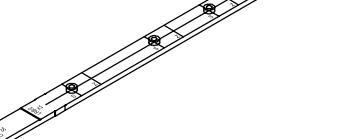
Profile accessory sets for parallel sliding and tilting fittings, depending on the sash width	Series	Drilling jigs for parallel sliding and tilting fittings	Series
<p><b>Z 993 425 02</b>  <b>Z 993 425 64</b>                      Profile accessory <b>Size 1</b>                      Length = 1930 mm                      For <b>sash width</b> = 650 - 930 mm</p>	1.0		<p><b>Z 912 205</b>                      Drilling jig for tandem rollers</p>
<p><b>Z 993 426 02</b>  <b>Z 993 426 64</b>                      Profile accessory <b>Size 2</b>                      Length = 2230 mm                      For <b>sash width</b> = 931 - 1080 mm</p>	•		<p><b>Z 912 206</b>                      Drilling jig for corner linkage gear</p>
<p><b>Z 993 427 02</b>  <b>Z 993 427 64</b>                      Profile accessory <b>Size 3</b>                      Length = 2630 mm                      For <b>sash width</b> = 1081 - 1280 mm</p>	•		<p><b>Z 912 211</b>                      Template for guide plate</p>
<p><b>Z 993 428 02</b>  <b>Z 993 428 64</b>                      Profile accessory <b>Size 4</b>                      Length = 3030 mm                      For <b>sash width</b> = 1281 - 1480 mm</p>	•		<p><b>Z 909 323</b>                      Drilling jig for turn handles and supporting pieces</p>
<p><b>Z 993 429 02</b>  <b>Z 993 429 64</b>                      Profile accessory <b>Size 5</b>                      Length = 3430 mm                      For <b>sash width</b> = 1481 - 1650 mm</p>	•		<p><b>Z 909 373</b>                      Drilling jig for guide rail</p>
<p><b>Z 993 456 02</b>  <b>Z 993 456 64</b>                      Profile accessory <b>Size 6</b>                      Length = 3830 mm                      For <b>sash width</b> = 1651 - 1850 mm</p>	•		<p><b>Z 909 374</b>                      Drilling jig for roller rail</p>
			<p><b>Z 909 375</b>                      Drill centring piece for drilling jigs <b>Z 909 373</b> and <b>Z 909 374</b></p>
			<p><b>Z 909 376</b>                      Drilling jig for guide plate secondary sash design</p>

Please observe the application diagrams!

cf. Processing Information

