

<b>76 057 0</b>		76 017-15 inside		76 059-25 outside	
A.a.o.	391 mm	A.P.i.	223 mm	A.P.a.	311 mm
A.m.	120 mm	Eckw.	77 008 0	Eckw.	77 009 0
				Gehr.W.	26 300 0
				St.Verb.	26 161 0

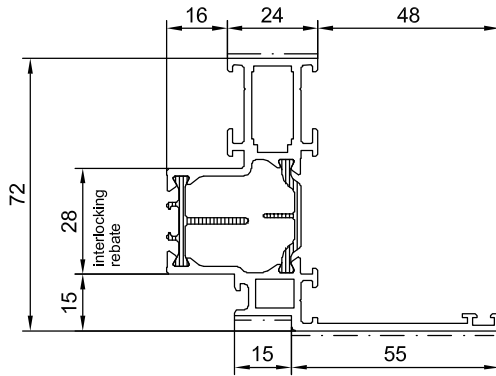

<b>78 063 0</b>		78 063-15 inside		78 063-25 outside	
A.a.o.	451 mm	A.P.i.	220 mm	A.P.a.	278 mm
A.m.	94 mm	Eckw.	93 006 0	Eckw.	77 151 0
				St.Verb.	26 161 0

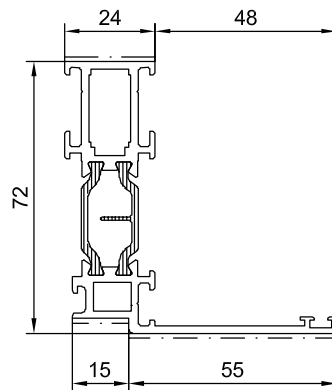

<b>78 064 0</b>		78 000-15 inside		78 064-25 outside	
A.a.o.	349 mm	A.P.i.	170 mm	A.P.a.	239 mm
A.m.	79 mm	Eckw.	93 006 0	Eckw.	77 151 0
				St.Verb.	26 161 0

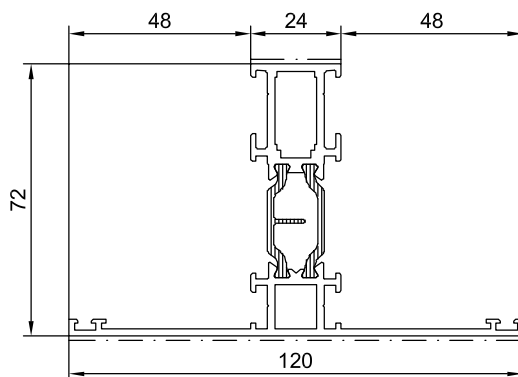

<b>78 000 0</b>		78 000-15 inside		78 000-25 outside	
A.a.o.	480 mm	A.P.i.	170 mm	A.P.a.	366 mm
A.m.	144 mm	Eckw.		Eckw.	
		Verb.	77 762 0	Verb.	77 663 0
		Di.St.i.	23 550 0	Di.St.a.	23 532 0
				St.Verb.	26 161 0

A.a. = outer perimeter  
 A.m. = perimeter mechanical  
 A.a.o. = outer perimeter without insulation zone  
 A.P.a. = perimeter outer profile  
 A.P.i. = perimeter inner profile  
 Eckw. = corner bracket  
 Gehr.W. = mitre angle  
 St.Verb. = T-bracket

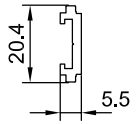



<b>52 350 0</b> untreated	
1 C 0	
2 C 35	
A.a.	62 mm
A.m.	

We recommend the use of slide-in profiles with anodised surface.

<b>76 940 0</b>	
A.a.	52 mm
A.m.	17 mm

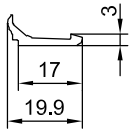
For anodised sash profiles only



<b>76 945 0</b>	
A.a.	55 mm
A.m.	17 mm

For painted sash profiles only

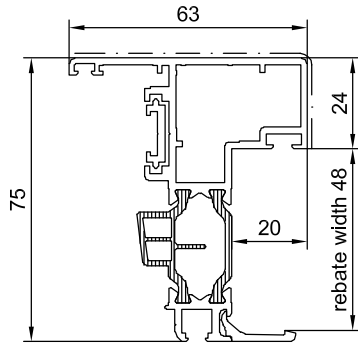
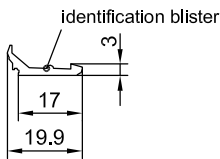

<b>76 942 0</b>	76 942-15 inside		235 116 <76 941-25> outside			
	A.a.o.	331 mm	A.P.i.	289 mm	A.P.a.	110 mm
	A.m.	87 mm	Eckw.	77 122 0	Eckw.	77 121 0
			Gehr.W.	26 300 0	St.Verb.	

stress rating
<b>3</b>

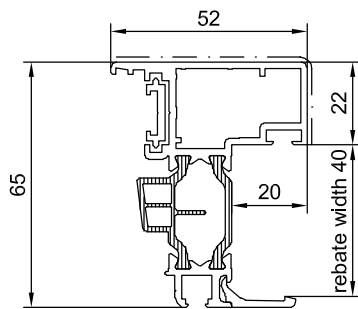

<b>76 943 0</b>	76 943-15 inside		235 116 <76 941-25> outside			
	A.a.o.	264 mm	A.P.i.	221 mm	A.P.a.	110 mm
	A.m.	74 mm	Eckw.	77 124 0	Eckw.	77 121 0
			Gehr.W.		St.Verb.	

stress rating
<b>1</b>

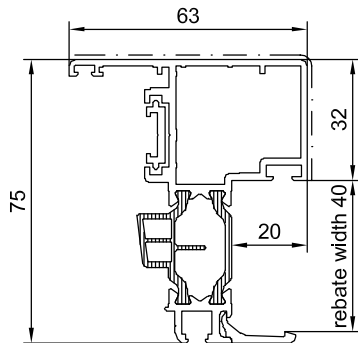

<b>76 941 0</b>	76 941-15 inside		235 116 <76 941-25> outside			
	A.a.o.	333 mm	A.P.i.	290 mm	A.P.a.	111 mm
	A.m.	95 mm	Eckw.	77 120 0	Eckw.	77 121 0
			Gehr.W.	26 300 0	St.Verb.	

stress rating
<b>3</b>

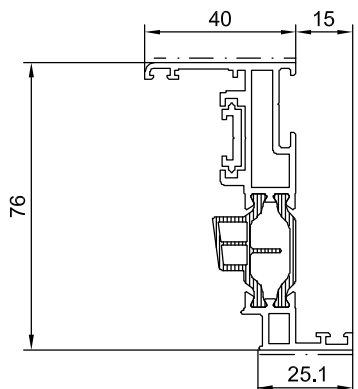

<b>78 001 0</b>	78 001-15 inside		78 001-25 outside			
	A.a.o.	325 mm	A.P.i.	246 mm	A.P.a.	125 mm
	A.m.	65 mm	Eckw.	77 056 0	Eckw.	77 055 0
			Gehr.W.	26 300 0	St.Verb.	

stress rating
<b>2</b>

A.a. = outer perimeter  
A.m. = perimeter mechanical  
A.a.o. = outer perimeter without insulation zone  
A.P.a. = perimeter outer profile  
A.P.i. = perimeter inner profile  
Eckw. = corner bracket  
Gehr.W. = mitre angle  
St.Verb. = T-bracket

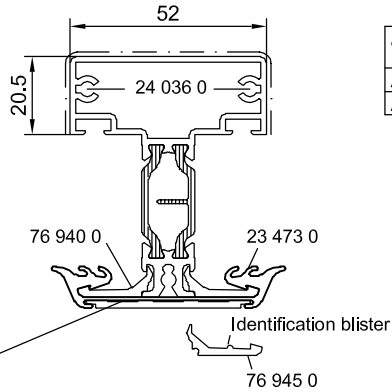
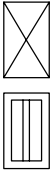

Glue aluminium profile 76 958 0 point by point  
using sealing material 912 718 <25 021 0> black  
or 912 717 <25 004 0> grey

<b>76 955 0</b>		76 955-15 inside		76 955-25 outside	
A.a.o.	251 mm	A.P.i.	206 mm	A.P.a.	107 mm
A.m.	93 mm				

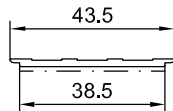

<b>76 958 0</b>	
A.a.	92 mm
A.m.	39 mm
delivery length 3 m	

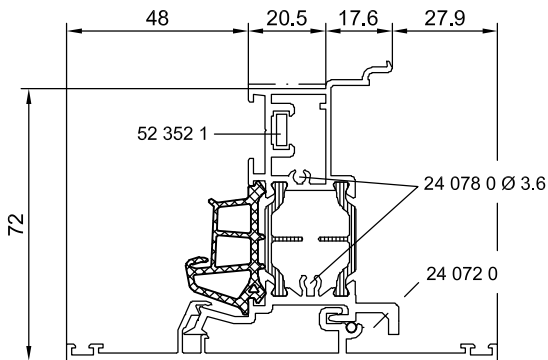

<b>76 949 0</b>		76 929-15 inside		76 949-25 outside	
A.a.o.	310 mm	A.P.i.	197 mm	A.P.a.	217 mm
A.m.	21 mm	Eckw.		Eckw.	
		Verb.		Verb.	
		Di.Sti.	23 501 0	Di.St.a.	23 502 0
				St.Verb.	

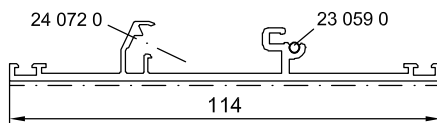

<b>76 950 0</b>	
A.a.	371 mm
A.m.	114 mm

A.a. = outer perimeter  
A.m. = perimeter mechanical  
A.a.o. = outer perimeter without insulation zone  
A.P.a. = perimeter outer profile  
A.P.i. = perimeter inner profile  
Eckw. = corner bracket  
Gehr.W.= mitre angle  
St.Verb. = T-bracket

interlocking frame profile for façades  
interlocking rebate with gasket 37 mm

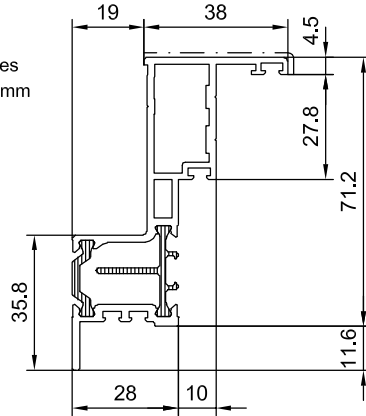

<b>74 015 0</b>		74 015-15 inside		74 015-25 outside	
A.a.o.	307 mm	A.P.i.	260 mm	A.P.a.	126 mm
A.m.	38 mm	Eckw.	77 066 0	Eckw.	
		Verb.		Verb.	

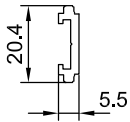

<b>52 350 0</b> untreated	
	<b>1</b> C 0
	<b>2</b> C 35
A.a.	62 mm
A.m.	

We recommend the use of slide-in profiles with anodised surface.

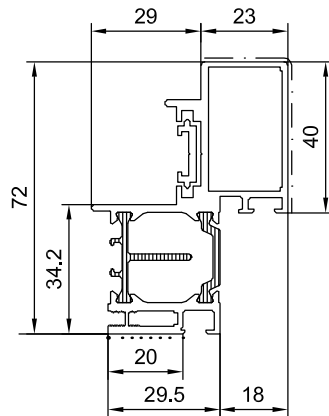

<b>74 905 0</b>		74 905-15 inside		74 905-25 outside	
A.a.o.	298 mm	A.P.i.	262 mm	A.P.a.	127 mm
A.m.	62 mm	Eckw.	77 064 0	Eckw.	53 068 0
				Eckw.	

..... Glue bonding area  
Anodized glue bonding area for SG-gluing

**In Individual cases an approval is required!**

A.a. = outer perimeter  
A.m. = perimeter mechanical  
A.a.o. = outer perimeter without insulation zone  
A.P.a. = perimeter outer profile  
A.P.i. = perimeter inner profile  
Eckw. = corner bracket  
Gehr.W. = mitre angle  
St.Verb. = T-bracket